

Manual Cortes XS



Your notes

This image shows a single sheet of white paper with horizontal ruling lines. The lines are evenly spaced and run across the width of the page. There are no margins, text, or other markings on the paper.

EXTEND YOUR
STANDARD
WARRANTY TO
10 YEARS

WWW.HUKA.CO.UK



Congratulations on your new Cortes XS

Would you like to cycle carefree? With your Cortes XS, we like to make your world easier. Probably you would rather go cycling than read the manual in detail. Therefore we have put together a manual which contains the most important and necessary information about the safe use of the Cortes XS. Please read this manual thoroughly before using the Cortes XS and always follow the instructions given in the manual.

To make the best use of your tricycle, I will give a few tips so that you can ride safely and with pleasure.

We are curious about your experiences and where you like to cycle. Would you share that with us on Facebook? We'd love to hear from you!

Warm regards,

Gabriel

Mechanic of the Cortes XS



Contents

Your notes 2

General..... 7

 Indication & intended use 7

 Warranty..... 8

 EU Declaration of Conformity..... 10

First bike ride on the Cortes XS..... 11

 Safe on the road 11

 Boarding and cycling..... 13

 Brakes 14

 Parking Brake 14

 Cycling with pedal assistance 16

 Moving and carrying the bicycle..... 17

Product Description 18

 Bike frame..... 18

 Drive..... 18

 Wheels and tires 19

 Spokes..... 19

 Chain case & chain..... 20

 Brakes 20

 Bottom bracket, crankset and pedals..... 20

 Gears..... 21

 Handlebar 21

 Lighting 21

 Seating system 22

Carrier	22
Electric pedal assistance	23
Pass Vario pedal assistance	23
Accessories	24
Fixing parts.....	25
Optimal use	26
Seat depth adjustment	26
Angle of backrest adjustment.....	27
stem height adjustment.....	28
stem angle adjustment	28
Handlebar stem with quick release	29
Wheels	30
Tire pressure	30
Best maintenance Cortes XS	31
Tire pressure & tread.....	32
Spokes.....	34
Chain	34
Brakes	34
Lighting	35
Battery charging.....	35
Mount Battery.....	36
Dismount battery.....	36
Replacement of parts.....	38
Specifications.....	39
Other information.....	41

Contact details Huka	41
Changes.....	41
Disposal product	42
Recycling the battery	42
Sale of the Cortes XS	43

General

INDICATION & INTENDED USE

Your Cortes XS is specially designed for people who need extra support in order to cycle stably and safely. This may be because you like to experience more stability or because of, for example, a neuromuscular condition that may affect coordination or natural movement capabilities.

- The Cortes XS is designed to be used on normal public roads and bike roads.
- The Cortes XS complies with all laws and regulations applicable to the use of public roads.
- It is your responsibility to comply with the specific safety requirements of the country in which you are riding. This also applies to possible insurance according to the relevant legislation including proper equipment of yourself and your bike that the country requires.
- As driver, you must be independently mobile and you must not have disabilities that prevent safe participation in traffic, such as an (audio) visual impairment.
- The maximum user weight and luggage weight (found in the Technical Specifications section) must not be exceeded.
- The bike is intended for one person.

WARRANTY

Huka has a standard 5-year warranty on the frame and front fork of your Cortes XS. You also have 2 years warranty on the battery and other parts. All warranty's are carried out by your Huka dealer.

- The warranty does not apply to damage or defects to the Cortes XS caused by improper or injudicious use. The assessment of this lies with Huka B.V. or a representative appointed by Huka B.V.
- Also, the warranty does not apply to parts subject to wear and tear, such as the chain, brakes and tires.
- Under no circumstances shall Huka be liable for any special or consequential damages due to negligence on the part of the user of the Cortes XS. Even if Huka has been notified of such damages. Applicable law may not permit the limitation or exclusion of liability or damages. So, the above limitation or exclusion may not apply on you.
- The warranty and product liability in general may be invalidated if instructions in this manual have not been followed. This will occur if unauthorized maintenance, technical modifications or additions have been made to the bicycle with non-original Huka parts without Huka's consent. Also the CE-mark will be cancelled. Missing a CE-declaration can lead to problems with the insurance of the bicycle and possible damage or liability.

TIP FROM GABRIEL Write down the frame and key number of your Cortes XS below. The frame number is important for guarantees, repairs or in case your bike is stolen for reporting to your insurance company. The frame number can be found under the seat system at the back of the bike on the frame.

Frame number

Key number

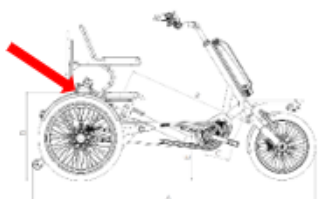

Location identification sticker



Huka BV
Munsterstraat 13, 7575 ED Oldenzaal
The Netherlands, Tel: +31 (0) 541 572472
SRN: NL-MF-000003494

Type/Typ :

Max gewicht/Max weight KG :

 2023-07
SN 2307184



Sample identification sticker



EU DECLARATION OF CONFORMITY

Manufacturer's name:	Huka B.V.
Address:	Münsterstraat 13, 7575 ED Oldenzaal The Netherlands
SRN:	NL-MF-000003494
Product type:	Tricycle bicycle
Trade name:	Cortes XS
Basic - UDI:	
Risk Class:	Class 1

Huka uses the following procedures for the CE marking of their products according to Regulation MDR 2017/745: Class 1: according to (EU) 2017/745 Annex VIII. This declaration of conformity is provided under the exclusive responsibility of Huka. We hereby declare that medical device(s) specified above comply with the provision of Regulation (EU) MDR 2017/745 for medical devices. This declaration is supported by the certified quality system according to ISO 13485:2016 issued by the Hallmark Institute and the relevant sections of the following harmonized standards: EN-ISO 14971: 2012 and EN 12182: 2012. All supporting documentation is kept at the manufacturer's premises. Signed on behalf of Huka,

Signed on behalf of Huka on November 2nd, 2024 at Oldenzaal, the Netherlands.

A handwritten signature in black ink, appearing to read "R. Lotgerink", with a long horizontal stroke extending to the right.

R. Lotgerink,
Managing Director



First bike ride on the Cortes XS

The time has come. Your first experience on your own Cortes XS! Whatever bike ride you make, your safety comes first! Should you be riding a Huka tricycle for the first time, it may take some experience. The most important tip we can give you is to relax as much as possible while cycling. To make everything will go smoothly, we give you some instructions.

TIP FROM GABRIEL Make sure the handlebars and saddle are properly adjusted before you ride your bike. This way you can have the right posture on the bike.

SAFE ON THE ROAD

In addition to your agility on the Cortes XS, which will continue to improve as you use it, it is important that your bike is in optimal condition when you hit the road. Please consider the following aspects:

- Before each use, check the condition and operation of brakes, tires, rims and steering.
- Keep in mind that braking characteristics change and braking distance may increase when the road surface is slippery.
- Make sure your luggage is secure and cannot shift.
- Cycle on flat and firm surfaces and avoid deep potholes, high thresholds, puddles of water and slopes exceeding 10%.
- Drive at an appropriate speed on wet or slippery surfaces, slopes or descents. Do not bump into curbs.
- Always lock your bike securely when you park it. Use the parking brake against rolling away.
- The Cortes XS is largely made of steel which is considered non-flammable. The other materials used such as plastic, rubber and the like are not fireproof.

- When driving on a steep slope, lean forward if necessary to avoid raising the front wheel. When riding down a slope brake gently until you come to a stop.
- Always take descents at moderate speed so that you can brake, and stop in time.
- Wear an appropriate bicycle helmet.
- Wear reflective clothing to increase visibility on the road.
- Extra caution is required during pregnancy due to increased risk of injury.

It is not recommended to cycle on a slope steeper than 10%, this involves an increased risk.

- Driving slowly on slopes is recommended.
- If stopped on a slope, ride off slowly, leaning forward if necessary to prevent the front wheel from losing contact with the ground.
- Are you rolling backwards on a slope? Then brake densely to prevent the front wheel is losing contact with the road surface.



Never be tempted to ride too enthusiastically on the roadway, such as going up and down sidewalks. Your Cortes XS may suffer (in)visible damage as a result, which can pose additional risks.

BOARDING AND CYCLING

Always use the parking brake when getting on or off the bike safely to keep it stationary. It is applied by squeezing the right brake lever (of the rear wheels) and then press on the locking pawl. If you release brake lever now, parking brake is engaged. To take the bike off the parking brake again, squeeze the brake lever briefly. Put it in first gear (if applicable) so you can pedal more lightly. As soon as you are seated and want to ride, release the parking brake.

- When getting on, take place on the seat and lift your foot to the other side of the bike. Place your feet on the pedals.
- Stay upright at all times and keep your feet on the pedals. Even when braking or standing still.

TIP FROM GABRIEL When cycling, steer with your arms and not your body. Cycling around corners takes some habituation. To maintain stability, lean your body slightly to the inside of the turn in sharp turns. Avoid sudden and violent steering movements. This way you will avoid accidents and damage.



Adjust your speed for cornering so that all wheels stay on the ground. Leaning inward will help with this.

TIP FROM GABRIEL When changing gears, make sure you stop pedaling and select the gear you want. Do not continue pedaling while changing gears. This can cause damage to the shifting mechanism. Damage to the gear hub due to abuse is not covered by the warranty.

BRAKES

The Cortes XS is equipped with hand brakes. Braking is done by squeezing both brake levers on the handlebars. The left hand brake operates the brake in the front wheel. The right hand brake operates the brakes on both rear wheels. When cornering, it is best to brake with the right hand brake. Practice braking first in a large enclosed area before going out on the road. You will become familiar with the system.



Be careful using the front brake when cornering. Using only the front brake in a turn may cause instability of the bicycle. This may result in personal or property damage.



Always use the parking brake when mounting or dismounting to prevent the bicycle from rolling away. This reduces the risk of falling.

PARKING BRAKE

Squeeze the right brake lever and push the pin down to engage the parking brake. To release the parking brake, simply squeeze and release the brake lever.

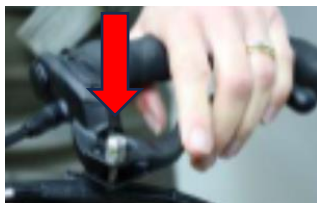

Squeeze the brake lever and Push down Lock pin

Optional additional parking brake lever is possible mounted on the stem.



Deactivated



Activated

You can activate this parking brake by pulling the lever all the way back. This puts the brake on the front wheel so your bike is safely parked.

TIP FROM GABRIEL Always use the parking brake when getting on and off the bike to prevent the bike from rolling away. You risk falling if the bike moves away from you.

CYCLING WITH PEDAL ASSISTANCE

Your Cortes XS is equipped with pedal assistance. The electric motor is turned on as soon as you start pedaling if the system is turned on. Pedaling becomes lighter. When you stop pedaling, the pedal assistance also stops. You activate the pedal assistance by pressing the On/Off button for 3 seconds.

- You turn on pedal assistance by pressing the on/off button on the display for three seconds. This also turns the pedal assistance off.
- You can adjust the support to different levels using the control buttons on the handlebars.
- Pressing the 'mode' key will take you through the menu on the display, The driven distance, range, driving time and speed are shown on it.

The detailed explanation of the pedal assistance can be found in the manual of the manufacturer of this assistance. First check which brand of pedal assistance is mounted.

BATTERY INDICATION

The display indicates how full the battery is. Check if the battery is full when you travel longer distances. The white block gets shorter as the battery gets empty. If the pad is completely white, the battery is full. There is also a battery indication on the battery itself. If the capacity of the battery is under 20% the assist will get less automatically to spare the battery.



Battery indicator
display Bafang

MOVING AND CARRYING THE BICYCLE

To move or carry the bike, you can grab the bike at the back by the frame tube and at the front by the head tube. We recommend lifting the bike with at least two people. While lifting, also hold the handlebars to prevent the front wheel and handlebars from spinning and possibly causing injury.



Exposure to bright sunlight can make various materials very hot.



The product contains moving parts. Consider the steering wheel, wheels, etc. Be alert of pinching hazards.



Vigilance is recommended when using electrical equipment such as a mobile when the electric drive is on.

Product Description

Your Cortes XS consists of several components. We describe the most important parts in this section.

BIKE FRAME

The frame of the Cortes XS consists of tubular metal construction supplemented by aluminum and stainless steel components. Most metal parts are phosphated and then provided with an impact-resistant powder coating. This construction and finish guarantee years of cycling fun.

DRIVE

The tricycle has its own specially designed drive on the rear wheels. This drive (with a differential) ensures that the bike does not pull askew and that turns can be taken easily.

Because of the differential, both wheels are driven independently of each other. This makes the bicycle go straight ahead and turns are easier to take.

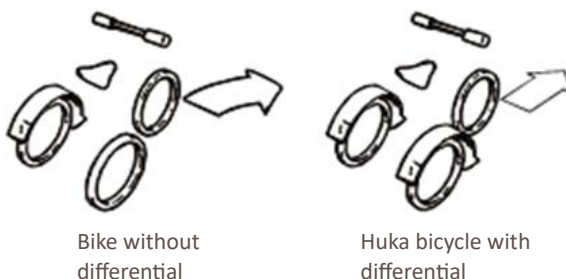

WHEELS AND TIRES

The wheels feature quality hubs, stainless steel spokes and an aluminum rim. A-quality anti-puncture tires are mounted on these wheels which ensure good grip, low rolling resistance and less wear.

TIP FROM GABRIEL Check tire pressure and tire wear regularly to ride safely. Tire pressure and tire wear have a great influence on the bike's handling.

The front wheel is mounted with a hub with two nuts in the front fork. These nuts must be tightened well to prevent the wheel is coming loose.



Always check if the front wheel is fixed well. Not fixed well front wheel hub can cause the wheel is coming loose which could pose additional risks.

SPOKES

Proper tension of the spokes ensures a stable tricycle. Because of the action of the new spokes, the wheels of your Cortes XS should be checked after 200 kilometers or 2 months. Your Huka dealer can take care of that. Should a spoke break or become loose, please consult your Huka dealer as well.

CHAIN CASE & CHAIN

The chain guard is made of an impact-resistant plastic. This chain guard protects the chain from dirt and water and also prevents the chain from soiling your legs or clothing.

With proper chain tension, your Cortes XS pedals lightly and you won't hear the chain. If you notice that the chain is too slack, have it adjusted by your Huka dealer.

BRAKES

The Cortes XS features a hydraulic disc brake on the front wheel and hydraulic disc brakes on the rear wheels. Your Huka is equipped with a parking brake that you use when getting on and off.

TIP FROM GABRIEL Brakes can wear out over time and are very important for safety while cycling. Have your brakes checked regularly and, if necessary, adjusted or replaced. Your Huka dealer can support you with this.



When mounting or dismounting, always make sure the parking brake is activated. This avoid the bike from rolling away.

BOTTOM BRACKET, CRANKSET AND PEDALS

Huka bottom bracket bearings are completely maintenance free and not adjustable. If there is any play on the bearing, please go directly to the Huka dealer. If play develops between the crank and bottom bracket, take off the dust cap and tighten the underlying bolt with a socket wrench 14.

Most pedals are maintenance-free. Is there too much play? Please consult your Huka dealer. When assembling the pedals yourself, pay attention to the indications L (left) and R (right) on the pedal axles. The left pedal you turn anti clockwise to fasten it. The right pedal has to be tightened clockwise. To do this, use a socket wrench 15 or a special (narrow) pedal wrench. Various pedals are optionally available.

GEARS

Your Cortes XS is equipped with gears, with the gear hub sitting between the pedals and the drive shaft. This is an 8-speed hub from Shimano type Nexus that is tuned to the Cortes XS, or optional an 3-speed hub automatic. Upon delivery, your Huka dealer has checked and properly adjusted the gears. The explanation of the gear hub can be found in the manual of Shimano.



Adjusting the gear hub is very specialized work. This should only be done by a Huka dealer.

HANDLEBAR

The handlebars of the bicycle can be steel or aluminum. This depends on the model of handlebars chosen. The handlebars are always adjustable in height. Some models of handlebars also have adjustable angle and depth.



The seat system and handlebars should always be securely tightened. Check this regularly. A loose seat system or handlebar can create an unsafe situation.

LIGHTING

The Cortes XS features lights connected to the battery. So, the lighting is not equipped with batteries.

SEATING SYSTEM

The seat system provides comfort and stability while cycling and is adjustable in depth and angle. It is very important to adjust the seat system correctly to cycle efficiently, comfortably and safely. A swivel seat system is optional and will make getting on and off the bike easier.



Periodically check that the seating system is securely tightened. A loose seating system can create unsafe situations.

CARRIER

The bike can optionally be equipped with a specially designed accessory adapter where various luggage systems can be easily mounted. Ask your Huka dealer about this, so that the right materials are used and the whole thing is mounted safely.



If you use the accessory adapter, distribute the load as best you can. The maximum load is 25 kg.



Changes to the accessory adapter affect its safety and is not permitted. The accessory adapter is not suitable for a trailer or bicycle seat.



If the accessory adapter is loaded it may affect the handling and braking characteristics of the bicycle. Make sure that lights and reflectors remain clearly visible at all times.



Luggage must be properly secured and distributed. Luggage not properly secured can be dangerous to participating traffic. Straps or straps should be properly secured to prevent them from getting into the wheel.

ELECTRIC PEDAL ASSISTANCE

The Cortes XS is equipped with electric pedal assistance. The bike is equipped with a center motor mounted to the frame in a specially designed adaption. The battery pack is mounted to the rear frame. There is also a clear display with controls mounted on the handlebars.



Bediening
op het stuur



Display en
het stuur



Motor unit



Accu pakket

PASS VARIO PEDAL ASSISTANCE

With the Pas Vario support, you pedal along and the pedaling is supported by the center motor at the crankset. The degree of support can be set with the control buttons on the handlebars and readable on the display. The bike is equipped with a Li-ion battery that is mounted with a special adapter on the front of the base frame.

ACCESSORIES

Your Cortes XS can be expanded with various accessories. Think of a foot fixation, another handlebar, cable lock, basket, mirror etc. More information can be found on the price list on our website or contact your Huka dealer.



FIXING PARTS

It is important that all parts on the bike are properly tightened. Various parts should be tightened with a torque. Use a torque wrench for this purpose. The table below shows values for the correct tightening torque. If in doubt, consult your Huka dealer for advice.

Section	Tightening torque
Handlebar stem/expander bolt	21-23Nm
Handlebar clamp bolt	21Nm
Bolts M8 back rest mounting	20Nm
Bolt M8 seat system	20Nm
Wheel nuts rear wheel	20Nm (Loctite blue)
Front wheel hub	35Nm



Failure to properly tighten parts can lead to unsafe situations.
Maintain the prescribed tightening torques.

Optimal use

Upon delivery of your new Huka, the components are properly adjusted to your body and tailored to your needs. To make sure you sit comfortably, there are adjustment options to flexibly adjust the seating system and handlebars.

SEAT DEPTH ADJUSTMENT

To adjust the seat depth, the following actions apply:

1. Turn the knob or lever anti-clockwise to unlock the seat.
2. Move the seat to the desired position by moving forwards or backwards. The seat then also changes in height to achieve the best sitting position.
3. Re-tighten the knob or lever clockwise and, if desired, move the seat back and front slightly to test whether the seat clamps properly on the slider.



The height of the seat automatically changes with it when the seat depth is adjusted, because the mounting tube slants upward. When the seat depth is adjusted correctly, the seat height will automatically be correct. With the seat in the correct position, you will pedal the miles away effortlessly.

TIP FROM GABRIEL A good rule for seat adjustment is to sit on the bike without shoes, with the crank in line with the seat tube. With the heel on the pedal you should then be able to just barely extend your leg. From this position you can adjust the seat height to the position that is most comfortable for you.

ANGLE OF BACKREST ADJUSTMENT

The back rest angle is individually adjustable and partly influential in creating a good seating position.

1. Using an Allen wrench to loosen the 2 M8 bolts 3 turns on both side.
2. Turn the backrest to the correct position and reattach it with the 2 bolts again. Try to move the backrest back and forward while fastening to secure the washer teeth will fit together good.
3. Retighten the bolts securely with 20Nm



All mounting bolts should be tightened properly after setting the correct seat and handlebar position. Not properly tighten bolts can be dangerous because it can cause the seat moving suddenly. See page 25 for right tightening torque

STEM HEIGHT ADJUSTMENT

1. Using a size 6 Allen wrench, loosen the stem bolt slightly to allow the handlebars to slide.
2. Pull or push the handlebars to the desired height. Make sure that the handlebar stem sticks into the frame enough so that the safety marking 'MIN' is not visible.
3. Retighten the stem bolt securely according to the described tightening torque on page 25.



Adjusting height of handlebar

STEM ANGLE ADJUSTMENT

1. Using a size 6 Allen wrench, loosen the adjustment bolt slightly to allow the handlebars to rotate.
2. Turn the handlebars to the desired angle.
3. Retighten the angle adjustment bolt securely according to the described tightening torque on page 25.



Stem angle adjustment

TIP FROM GABRIEL Sometimes the stem is very tight and cannot be moved even with a loosened stem bolt. Take a plastic hammer and hit the stem bolt once. It will shoot down slightly, then the handlebar will come loose.

HANDLEBAR STEM WITH QUICK RELEASE

1. Slide the locking tab up
2. Pull up the lever
3. Place handlebars in desired position
4. Push the lever closed again until the locking tab clicks into place

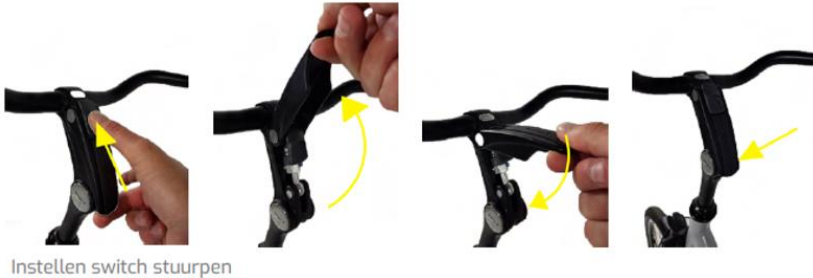

The lever must close with a resistance of 120-150N. Otherwise, the handlebar may slip loose during cycling which can lead to serious injuries.

WHEELS

The wheels help ensure light running and high riding comfort. Properly inflated tires, tightly tensioned spokes and light clearance are important for optimal cycling comfort.

TIP FROM GABRIEL Before cycling, check that the wheels turn smoothly and do not creak while cycling. Crackling noises often indicate a loose spoke or a defective bearing. Contact your Huka dealer in this case.

TIRE PRESSURE

Make sure you always inflate your tires properly. This will prevent wear and tear on the tires of your Cortes XS. It also makes cycling more comfortable and allows you to react better to braking and steering movements. The right tire pressure has been reached when you can press the tire just a little with your thumb. More information about tire pressure can be found on page 32.

Best maintenance Cortes XS

Optimal riding comfort is created by maintaining the bicycle properly. In this chapter we will show you how to do this. We also advise you to let your Huka dealer do the yearly maintenance. They check the Cortes XS for functionality, safety and possible wear.



After about 200 kilometers or after 2 months you should have the first service done by your Huka dealer. They will inspect the nuts, chain and spoke tension etc. If you have the maintenance done by a non-Huka dealer, this may affect the warranty.

CLEANING

Clean the bicycle regularly. Use lukewarm soapy water in combination with a mild detergent. Clean the rims with lukewarm water and a soft brush. Do not use a wire brush. This will damage the rims. The use of a high-pressure cleaner is not recommended. The high pressure blows the grease out of the bearings. Rinsing with a garden hose is fine, as long as the jet is not too powerful. Dry the bike with a cloth.

TIRE PRESSURE & TREAD

Check tire pressure and tread regularly for optimal grip on the road. The Cortes XS can be inflated with a normal bicycle pump. The desired tire pressure is 4 bar. After inflating, check that the valve does not leak. Spread some saliva over the valve tube. If an air bubble appears, the valve is flat and must be replaced. If the tread is less than 1 mm deep, then the tires should be replaced. Your Huka dealer can support you with this.

To replace the inner and/or outer tire, apply the following sizes:

- Inner and outer tire front wheel: 55-305
- Inner and outer size rear wheels : 55-406

TIP FROM GABRIEL In case of a malfunction, contact your Huka dealer immediately. Do not use the bike until the malfunction is corrected.

TIRE PASTE

Have you found out that a tire on the Cortes XS is flat? Your Huka dealer can, of course, patch the tire. But if you want to do it yourself, here are the instructions:

Needed: a repair kit (with tire levers, glue, stickers and sandpaper), trestle or jack, scissors, bicycle pump and a bucket of water.

- Deflate the tire and unscrew the valve.
- Insert the first tire lever next to the valve (between the outer tire and the rim) and hook it behind a spoke.
- Do the same with the second tire lever (about two spokes away).
- Using the third tire lever, gently rock the tire loose.
- Remove the outer tire from the rim. Feel for anything sharp (glass, nail, etc.) on the inside of the outer tire. Remove the inner tube from the wheel.
- Inflate the tire and find the leak by holding the tire under water. Where bubbles appear is where the leak is.
- Deflate the tire and lightly sand the puncture site. Spread some glue on the tire and let it set for two minutes.
- Use a ready-made sticker or cut out a round from the piece of tire patch. Stick this on the puncture and press firmly. Let it dry for 5 minutes.
- Place the valve back into the rim and assemble. Wait to tighten the thin nut until the entire tire is back on the bike.
- Inflate the inner tube slightly and place it in the outer tire. Press the outer tire into the rim all around. Start at the valve and slowly work around.
- Pump the tire to the correct pressure. Check that the outer tire sits nicely on the rim. Tighten the small nut on the valve. The tire is glued!

SPOKES

The spokes should be checked for tension once a month. A loose spoke usually produces creaking noises. A loose spoke can cause the rim to warp which affects cycling. The spoke check is easily performed by strumming the finger along the spokes like on a guitar. A spoke with an abnormal tone is likely to be loose. Your Huka dealer can perform the repair for you.

CHAIN

The chain should be cleaned and lubricated once a quarter. In addition, the chain tension should be checked regularly. We recommend that this work be performed by a Huka dealer.

BRAKES

Regularly test the functionality of the brakes. A brake that is too slack does not brake adequately. The brakes can be adjusted a little tighter with the adjusting nut inside the brake handle.



The braking on the front and rear wheels is provided by a hydraulic disc brake. This is a closed system filled with brake oil that does require just a little adjustment because of wear of the brake pads. If a hydraulic brake does not work properly indicates worn pads or air in the brake system. Always have an improperly functioning rear brake checked by your Huka dealer.



Are the brakes not adjustable or does the Cortes XS still not brake properly? Then have it checked by your Huka dealer.

LIGHTING

The headlight and rear light are connected to the pedal assist battery. The system will automatically turn on the light when it is getting dark.

The lighting can be turned off by pressing the lighting button on the handlebar.

BATTERY CHARGING

The Cortes XS comes standard with pedal assistance. Before you start cycling, check whether the battery is still sufficiently charged using the battery indication. Depending on the capacity, charging takes between 3 and 6 hours. Always use the original battery charger supplied. Charging follows the steps below.

1. Turn off the power and insert the charging plug in the battery.
2. Plug in the mains plug of the charger on the mains power.
3. If the led on the charger is green the battery is fully charged and you can disconnect the mains plug and charging plug.



MOUNT BATTERY

1. Turn the battery clockwise and then push it in firmly until you feel the lock clicks.
2. Turn the key clockwise back to the locked position and remove the key.
3. Always check if the battery is mounted en locked well by turning the battery anti clockwise with your hands.

DISMOUNT BATTERY

1. Turn off the power and insert the key into the battery case lock cylinder.
2. Turn the key anti clockwise until you feel slight resistance so that it is in the unlocked position.
3. Carefully remove the battery or attach the adapter to the charging plug.



TIP FROM GABRIEL A low ambient temperature has a detrimental effect for charging a battery. At temperatures below 10 degrees, it is best to take the battery inside and charge it at room temperature.

Tips for safe charging:

- Use only the original charger
- Hang a smoke detector in the room where you charge your battery.
- Preferably charge your battery during the day so you can take quick action when needed.
- Do not expose your battery to freezing temperatures, full sun or moisture; instead, charge and store your battery at room temperature. This will prevent overheating and damage.
- Place your battery in a stable, free and non-flammable place during charging.
- Do not charge a battery if it is hot to the touch. If the battery becomes very hot during charging, stop charging and move the battery to a safe place, preferably outside.

Tips for extending life:

- Do you use your battery infrequently? Charge your battery at least every three months. A battery drains slowly, which can damage it if the voltage is too low.
- Use only the supplied/recommended charger. Imitation chargers can damage your battery, even though they sometimes have the same specifications.
- Remove your battery from the charger when it is 100% charged. This will extend the life of the battery.



Batteries and battery chargers with mechanical damage caused, for example, by falling or bumping, damage from heating or water pose a high fire risk. Do not charge them or try to repair them. Put it outside and inform your dealer/bicycle shop.

REPLACEMENT OF PARTS

Is your Cortes XS defective or need parts replaced? We advise you to have this done by your Huka dealer. Partly this will prevent that the factory warranty expires.



Always have original Huka parts mounted on the bike. Your Huka dealer can take care of this.

Specifications

	Standard version
Frame material	anti-corrosion treated steel
Finish	exterior grade epoxy powder coating
Color	More colors available. See price list
Wheels	double-walled rim and hub with stainless steel spokes
Tires	A-brand (anti-puncture)
Drive	freewheel axle with differential in rear axle
Gear hub	8-speed Shimano Nexus hub
E-drive	Bafang M410 center motor 250W - 80 Nm
Lighting	LED lighting front and rear, handlebar controls
Bell	sporty and lightweight bell, type Decibel
Fenders	impact and shape resistant plastic
Chain Protection	Hebie Chainglider
Handlebar	sporty curved design handlebars
grip	rubber
Seating system	low back, non-rotating. Seat angle and depth adjustment.
Pedals	metal with anti-slip
Front brakes	Hydraulic disc brake
Rear brakes	hydraulic disc brakes incl. parking brake
Suspension	adjustable suspension

	Standard version
Length total in mm (A)	1750
Width overall in mm (M)	785
Weight in kg	38
Crank length in mm (D)	150
Inside leg length in mm (B)	670-950
Seat height to ground in mm (C)	600-670
Rear frame height in mm (G)	600
Entry height in mm (E)	360
Handlebar height adjustment in mm (F)	250
Handlebar width in mm	650
Maximum load in kg	110
Tire size front in ETRTO	55-305
Front tire size in inches	16 x 2.10
Rear tire size in ETRTO	55-406
Rear tire size in inches	20 x 2.10

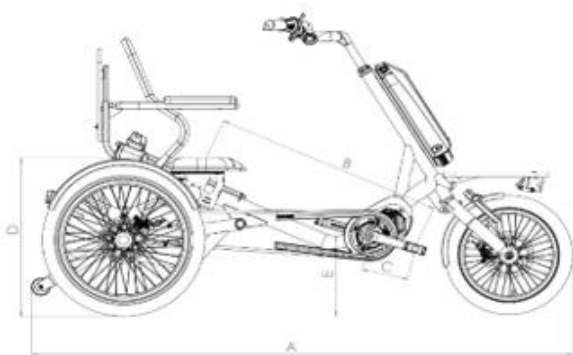

Other information

CONTACT DETAILS HUKA

Do you have questions about our product development? Or do you have suggestions to improve our Huka bicycles? Then please contact us.

Munsterstraat 13
7575 ED Oldenzaal
0541-572472
info@huka.nl
www.huka.nl

For questions regarding the maintenance of your Cortes XS, please refer to your Huka dealer.

CHANGES

Huka follows the philosophy of continuous product development and improvement. As a result, the product delivered can be different from the images shown. Huka BV reserves the right to make changes to the product as described in these instructions for use. No liability is due for this. Printing errors reserved.

For the most current version of the manual, visit www.huka.nl/handleiding.

TIP FROM GABRIEL Do you have questions about the maintenance of your Cortes XS? Your Huka dealer will support you. In this manual we give you tips how to maintain your bike.

DISPOSAL PRODUCT

Are you no longer using the Cortes XS? Then contact your Huka dealer. They can guide you with a possible sale or trade-in of it. If you want to dispose of your Cortes XS, you can also contact your local waste disposal company. They will dispose of the bike according to the regulations and laws in force in your hometown.



If you want to replace batteries or battery on your bicycle, keep in mind that it is chemical waste. Therefore, make sure it is disposed of properly by returning the battery to a Recycle collection point.

RECYCLING THE BATTERY

When the battery is defective or when you no longer use it, you should have it recycled. You can do this at a Battery recycle collection point. Go to your local waste disposal company for more information.

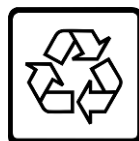

Li-ion

SALE OF THE CORTES XS

If you want to sell your Cortes XS to another user, it is important that you hand over all the necessary technical documentation so that the new owner can use the bike safely.

We recommend that you have the bike checked by your Huka dealer before the sale to make sure the Cortes XS is sold in good condition. Want to buy a used Huka bike? Then we advise you to have it checked by your Huka dealer beforehand. They can check it for wear and tear and hidden defects.

Huka makes your world easier

To best meet the needs of individual riders, we believe good service is essential! Huka is known for its good service and far-reaching commitment. Do you own a Huka bike and would like to have periodic maintenance done? Our dealers are happy to perform all maintenance work for you!

Your Huka dealer

Huka 0541-572 472 info@huka.nl

44

